

RADIO REMOVAL: 2005-2010 LX

NOTE: A battery reconnect procedure must be performed anytime the battery has been disconnected (see pgs 4-6.)

NOTE: REQ radios only must be put into "Transportation Mode" before removal. With Ignition in RUN or ACCESSORY, press SET and DISK simultaneously until the radio displays "TRANSPORTATION" on the display or for 5 seconds.

1. Disconnect and isolate the battery negative cable.
2. Remove the instrument panel center bezel (see pages 2-3)
3. Remove the mounting fasteners.

CAUTION: Pulling the antenna cable straight out of the radio without pulling on the locking antenna connector could damage the cable or radio.

4. Disconnect the antenna cables.
5. Disconnect the electrical connectors and the remove radio.

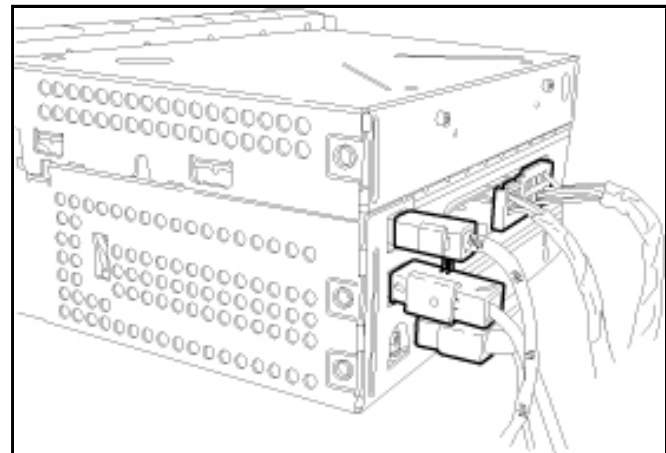
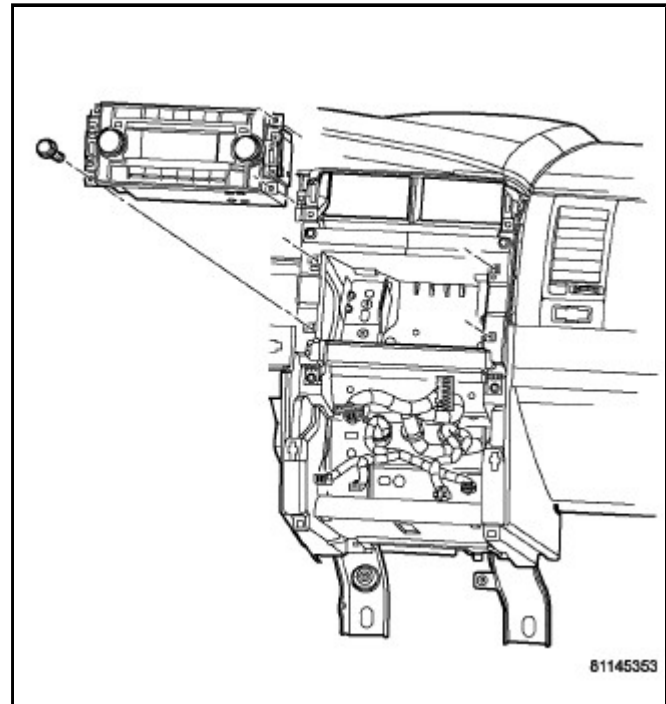

CHRYSLER 300

1. Before proceeding with the following repair procedure, review all warnings and cautions.
2. Using a trim stick C-4755 or equivalent (1), remove the center bezel (2) from the instrument panel (3) by releasing the snap retainers from the instrument panel.

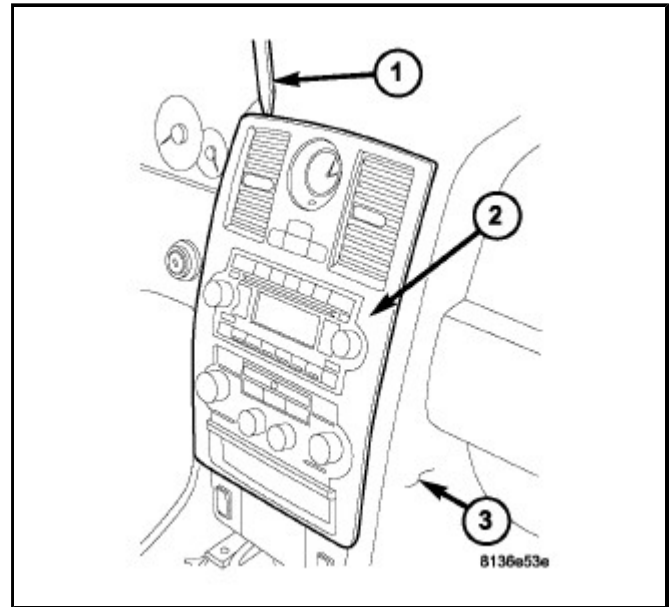

3. Disconnect the electrical connectors (3) from the A/C - heater control (4) and the clock and remove the center bezel (1) from the vehicle.

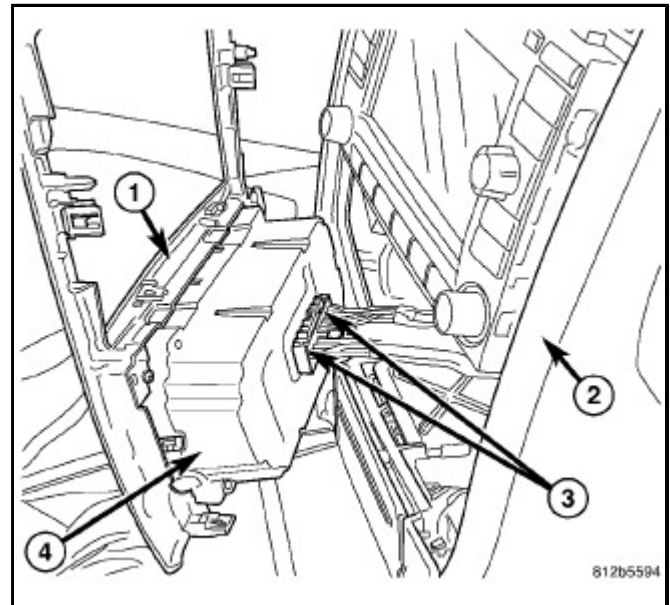

DODGE CHARGER / MAGNUM

1. Before proceeding with the following repair procedure, review all warnings and cautions.
2. Using a trim stick C-4755 or equivalent (1), remove the center bezel (2) from the instrument panel (3) by releasing the snap retainers from the instrument panel.

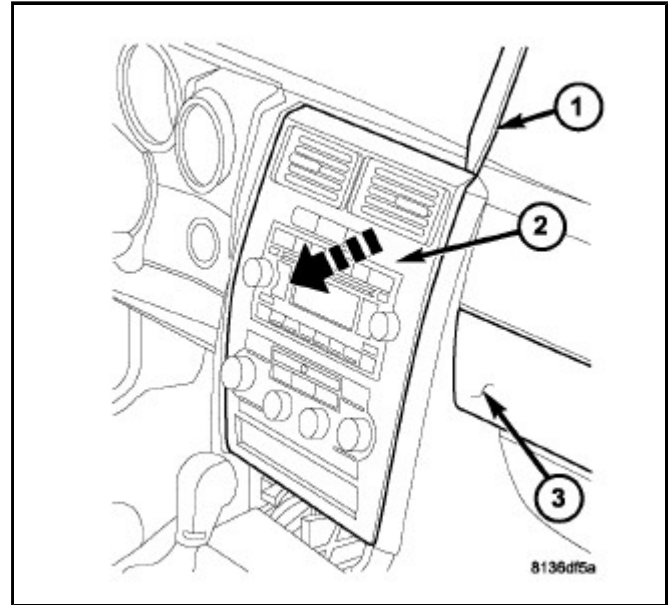

3. Disconnect the electrical connectors (3) from the A/C - heater control (4) and the switch pod and remove the center bezel (1) from the vehicle.

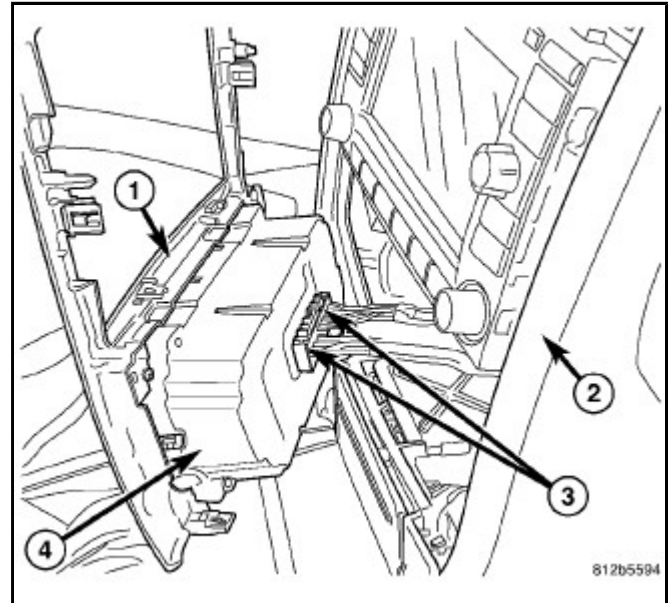

BATTERY RECONNECTION: 2005 models

NOTE: This reconnection procedure is to be performed anytime the battery has been disconnected.

1. Connect the battery negative cable (2) to the battery post and tighten the clamp nut.
2. Install the rear compartment floor trim panel.

CAUTION: Once the battery has been connected, review and perform the following information as applicable.

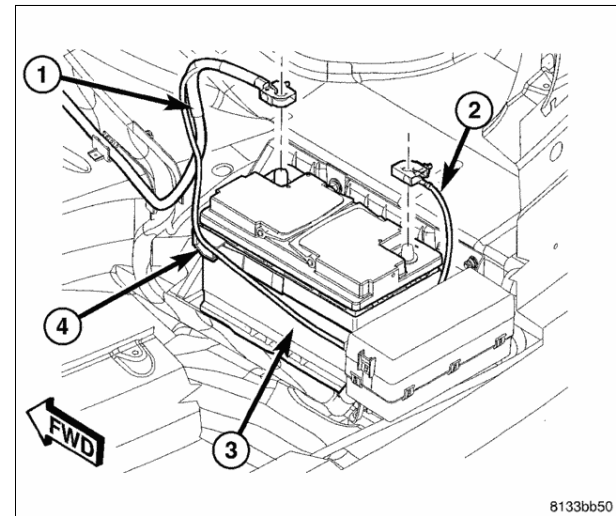

AUTO UP FRONT WINDOW

If the vehicle is equipped with the auto-up front window feature, once the battery is reconnected the door module needs to be calibrated. The door module requires calibration anytime the battery or door module has been disconnected for any length of time. To calibrate, perform the following:

1. Turn the Ignition to the Run position.
2. Regardless of current window position, move the driver side front window upward until the window stalls in the full up position. Allow the window motor to stall for at least 2 seconds before releasing the switch.
3. Move the driver side front window downward until the window stalls in the full down position. Allow the window motor to stall for at least 2 seconds before releasing the switch.
4. Move the driver side front window upward until the window stalls in the full up position. Allow the window motor to stall for at least 2 second before releasing the switch.
5. Repeat steps 2, 3 and 4 for the passenger side front window.
6. Verify the windows are properly calibrated by operating the express down and up features on the windows. Repeat this procedure if the calibration failed. If unable to properly calibrate after the second attempt, check the Driver's Door Module (DDM) and Passenger's Door Module (PDM) for Diagnostic Trouble Codes (DTCs) and correct as required.

ELECTRONIC STABILITY PROGRAM (ESP)

If the vehicle is equipped with ESP, once the battery is reconnected, the Steering Angle Sensor (SAS) needs to be calibrated. The SAS requires calibration anytime the battery or an ABS (ESP) component has been disconnected for any length of time. **If the SAS is not calibrated following battery reconnection, the ESP/BAS indicator lamp is illuminated following 5 ignition cycles indicating the need for calibration.**

To calibrate, perform the following:

1. Start the engine.
2. Center the steering wheel.
3. Turn the steering wheel all the way to the left until the internal stop in the steering gear is met, then turn the wheel all the way to the right until the opposite internal stop in the steering gear is met.
4. Center the steering wheel.
5. Stop the engine.

BATTERY RECONNECTION: 2006-2010 models

NOTE: This reconnection procedure is to be performed anytime the battery has been disconnected.

1. Connect the battery negative cable (2) to the battery post and tighten the clamp nut.
2. Install the rear compartment floor trim panel.

CAUTION: Once the battery has been connected, review and perform the following information as applicable.

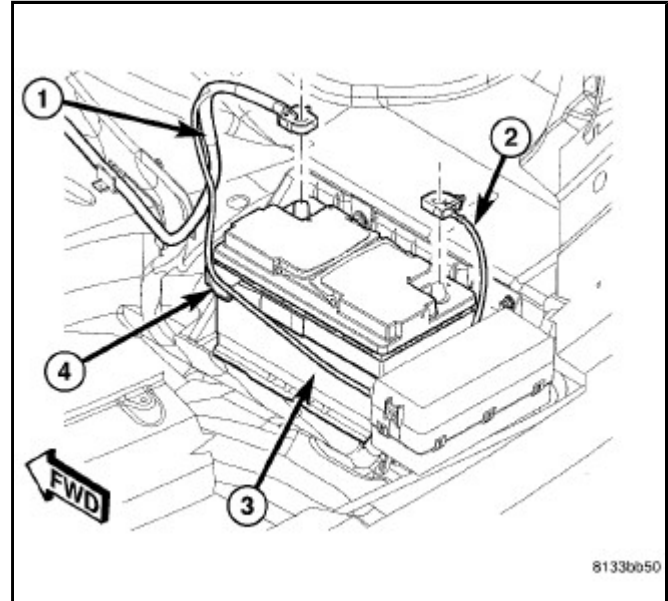

EXPRESS FRONT WINDOW(S)

NOTE: Make sure battery is fully charged before proceeding.

NOTE: This needs to be completed every time the window glass is adjusted/removed, motor replaced, and or regulator replaced.

CLEAR/DENORMALIZE USING A SCAN TOOL

To clear/denormalize the door module memory, using a scan tool under the Miscellaneous menu look for Denormalization Window Command, and follow the directions.

RELEARN/NORMALIZE USING A SCAN TOOL

To relearn/normalize the door module memory, using a scan tool under the Miscellaneous menu look for Normalization Window command, and follow the directions.

CLEAR/DENORMALIZE, RELEARN/NORMALIZE WITHOUT A SCAN TOOL

Hold up/down the window switch for at least 30 seconds until the DTC is set for stuck switch. This will clear the memory of the calibration information (CLEAR/DENORMALIZE). Proceed to relearn/normalize.

1. Put a battery charger on vehicle.
2. If equipped with express-up/express-down, reset the express-up/down module for the door window glass. The window switch on the corresponding door must be used to control the window. Do not use the master switch for the passenger window.
3. To calibrate, start by moving the window to the middle position.
4. Drive the glass to the full-up position by pulling up on the window switch to its second detent and hold the switch until the glass is fully closed. Do not release the window switch. Continue to hold the window switch up for 2 seconds after the window glass is full closed.

5. Drive the glass to the full - down position by pushing down (depress) the window switch, (second detent if equipped with express-down) until the window glass is down for 2 seconds after the window glass is fully open. Do not release the window switch. Continue to hold the window switch down for 2 seconds after the window glass is fully open.
6. Check the operation of the express-up/ express-down feature.
7. If the express up/down doesn't work, repeat step # 3, waiting for 3 seconds.
8. Check that the window glass reverses when in the express-up mode by holding a pen in the path of the glass.
9. Once the proper operation of the express-up/express-down feature has been verified, clear all Diagnostic Trouble Codes (DTC's).

ELECTRONIC STABILITY PROGRAM (ESP)

If the vehicle is equipped with ESP, once the battery is reconnected, the Steering Angle Sensor (SAS) within the Antilock Brake Module (ABM) needs to be calibrated. The SAS requires calibration (initialization) using the scan tool anytime the battery or an ABS (ESP) component has been disconnected for any length of time. **If the SAS is not calibrated following battery reconnection, the ESP/BAS indicator lamp will flash continuously with no DTCs.**

To calibrate (initialize), perform the following:

1. Position the front wheels straight ahead and center the steering wheel.
2. Connect the scan tool to the vehicle.
3. Follow the directions on the scan tool.