

F58-C REMOVAL

NOTE: REQ radios only must be put into "Transportation Mode" before removal. With Ignition in RUN or ACCESSORY, press SET and DISK simultaneously until the radio displays "TRANSPORTATION" on the display or for 5 seconds.

NOTE: A battery reconnect procedure must be performed anytime the battery has been disconnected (see page 3).

1. Disconnect and isolate the battery negative cable.
2. Remove the instrument panel center bezel (see page 2)
3. Remove the mounting fasteners.

CAUTION: Pulling the antenna cable straight out of the radio without pulling on the locking antenna connector could damage the cable or radio.

4. Disconnect the antenna cables by pulling the locking antenna connector away from the radio.
5. Disconnect the electrical connectors and remove the radio.

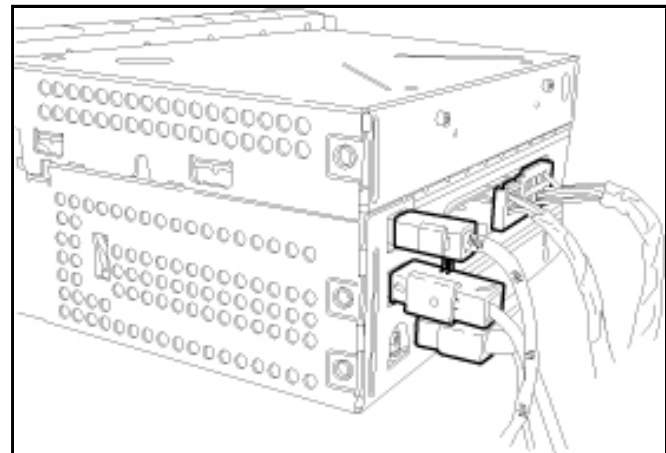
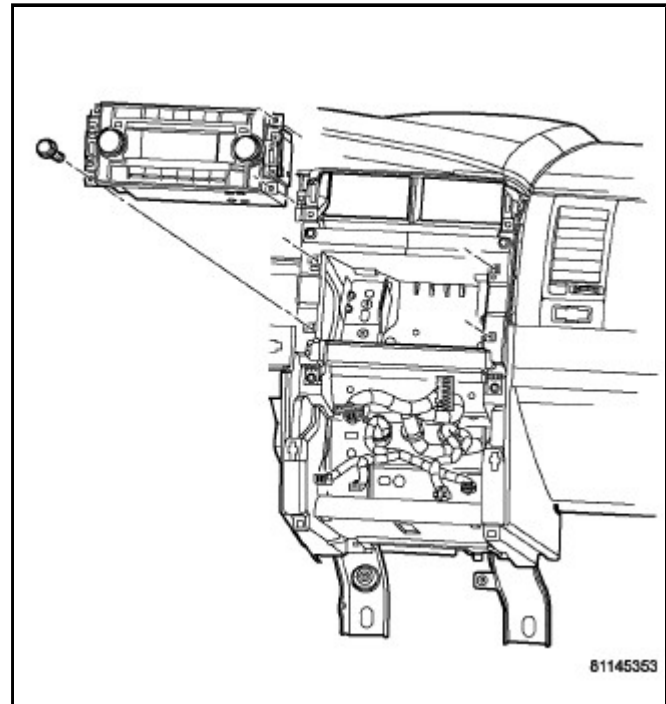

REMOVAL

1. Before proceeding with the following repair procedure, review all warnings and cautions.
2. Using trim stick C-4755 or equivalent, remove the center bezel (2) from the instrument panel (1) by releasing the snapretainers from the instrument panel.
3. Disconnect the electrical connectors.
4. Remove the center bezel from the vehicle.

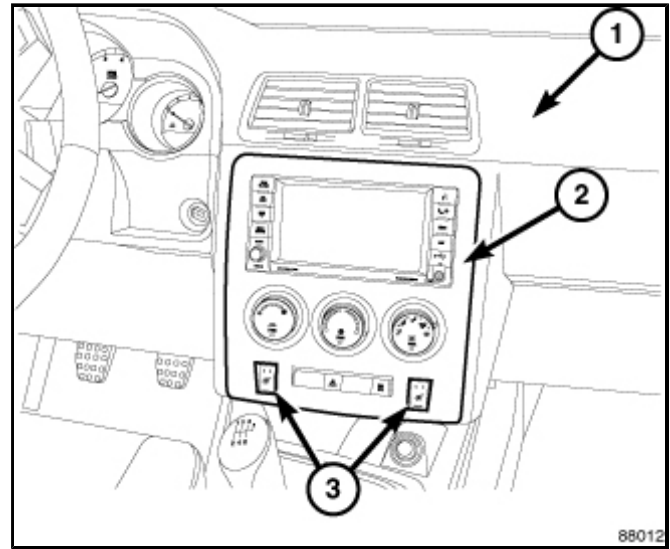

BATTERY RECONNECTION

NOTE: This reconnection procedure is to be performed anytime the battery has been disconnected.

1. Connect the battery negative cable (2) to the battery post and tighten the clamp nut.
2. Install the rear compartment floor trim panel.

CAUTION: Once the battery has been connected, review and perform the following information as applicable.

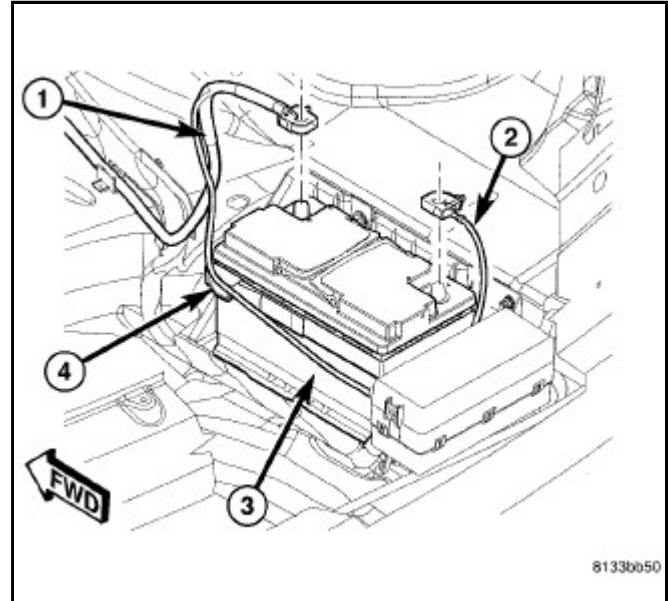

AUTO UP FRONT WINDOW

If the vehicle is equipped with the auto-up front window feature, once the battery is reconnected the door module needs to be calibrated. The door module requires calibration anytime the battery or door module has been disconnected for any length of time. To calibrate, perform the following:

1. Turn the Ignition to the Run position.
2. Regardless of current window position, move the driver side front window upward until the window stalls in the full up position. Allow the window motor to stall for at least 2 seconds before releasing the switch.
3. Move the driver side front window downward until the window stalls in the full down position. Allow the window motor to stall for at least 2 seconds before releasing the switch.
4. Move the driver side front window upward until the window stalls in the full up position. Allow the window motor to stall for at least 2 second before releasing the switch.
5. Repeat steps 2, 3 and 4 for the passenger side front window.
6. Verify the windows are properly calibrated by operating the express down and up features on the windows. Repeat this procedure if the calibration failed. If unable to properly calibrate after the second attempt, check the Driver's Door Module (DDM) and Passenger's Door Module (PDM) for Diagnostic Trouble Codes (DTCs) and correct as required.

ELECTRONIC STABILITY PROGRAM (ESP)

If the vehicle is equipped with ESP, once the battery is reconnected, the Steering Angle Sensor (SAS) within the Antilock Brake Module (ABM) needs to be calibrated. The SAS requires calibration (initialization) using the scan tool anytime the battery or an ABS (ESP) component has been disconnected for any length of time. **If the SAS is not calibrated following battery reconnection, the ESP/BAS indicator lamp will flash continuously with no DTCs.**

To calibrate (initialize), perform the following:

1. Position the front wheels straight ahead and center the steering wheel.
2. Connect the scan tool to the vehicle.
3. Follow the directions on the scan tool.